



transforms
SMART BEDS

Advanced Technology for Beds

Mod. Desk

Biurko / desk

Istrukcja montażu / Assembly instructions

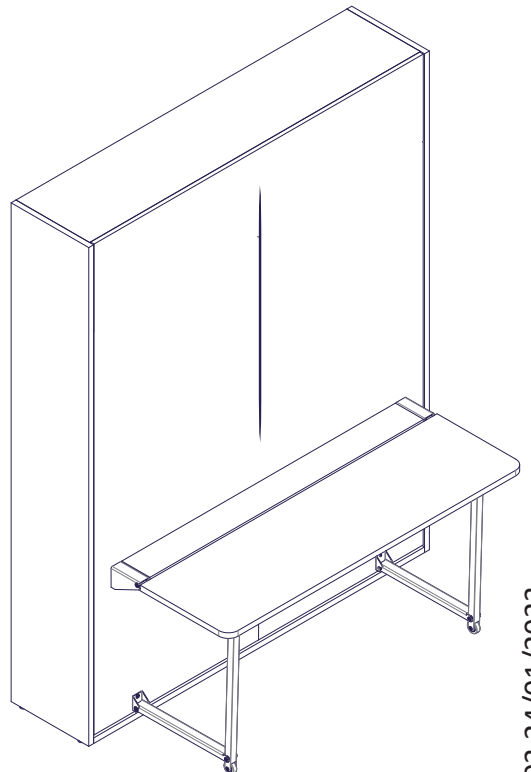
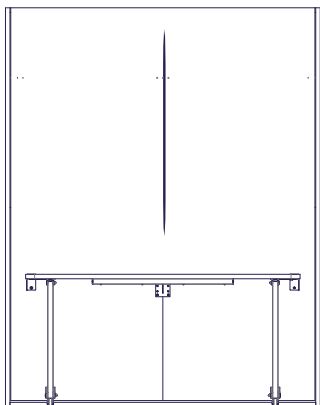
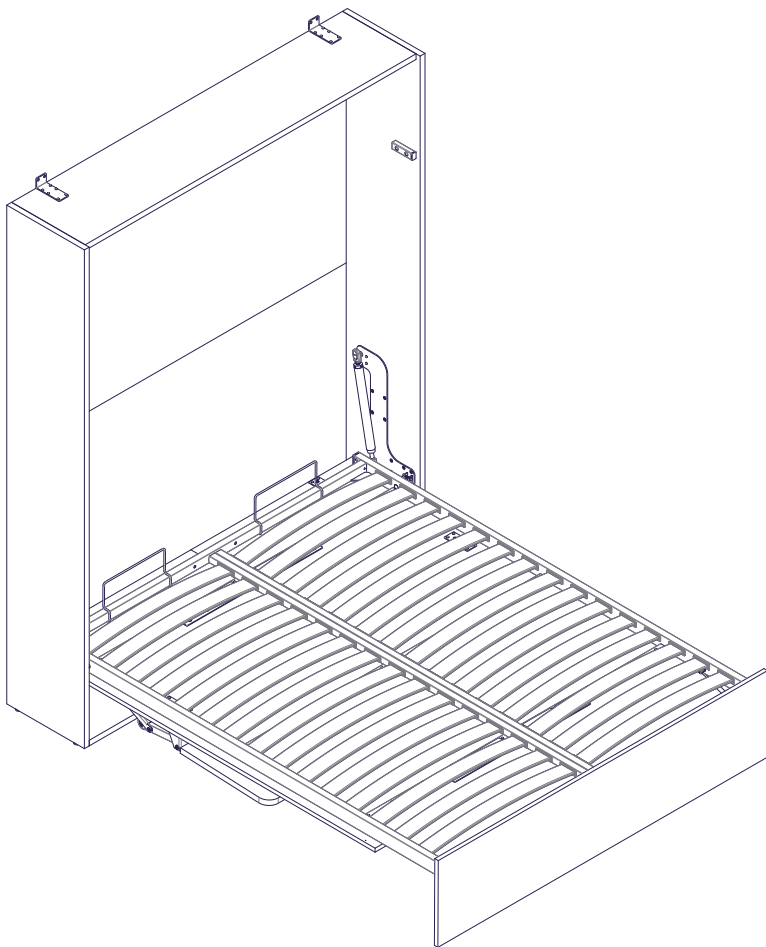

MADE IN EU

A103 24/01/2023

ENGLISH POLSKI

Istrukcija montažu / assembly instructions

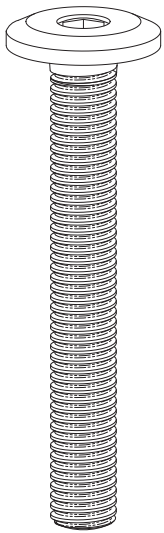

A
M8x60

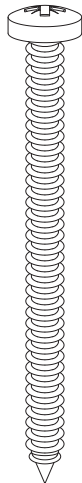

B
4x50

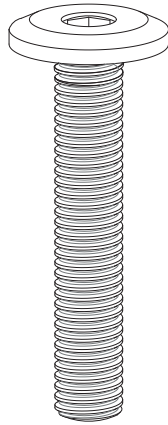

C
M8x45

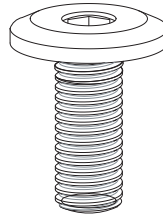

D
M8x20

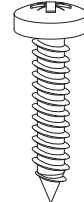

E
4x20

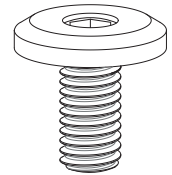

F
M6x12

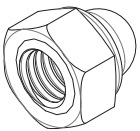

G
M8

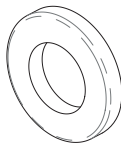

Hx4
Nylon

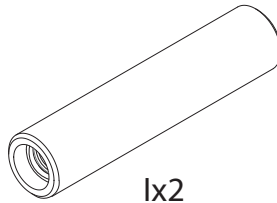

Ix2
M8

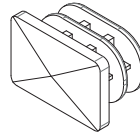

Jx2
M8

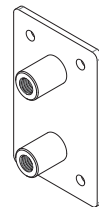

Kx2

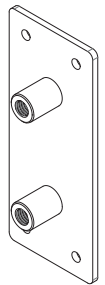

Lx2

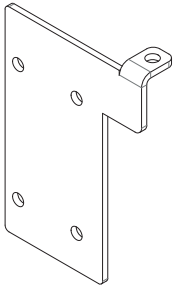

Mx1

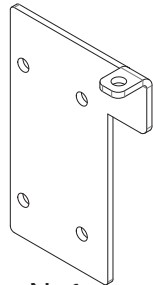

Nx1

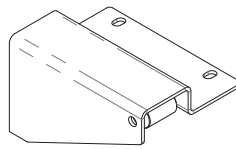

Ox1

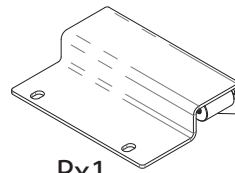

Px1

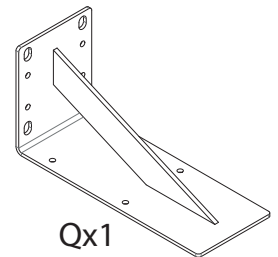

Qx1

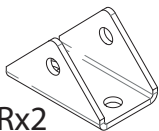

Rx2

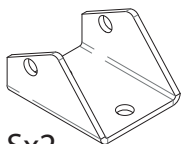

Sx2

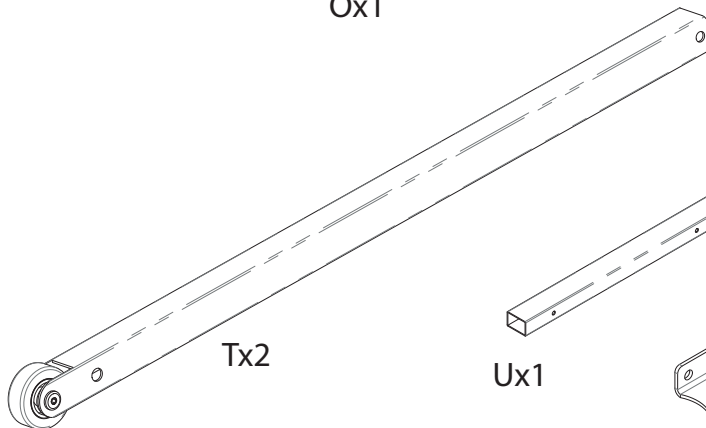

Tx2

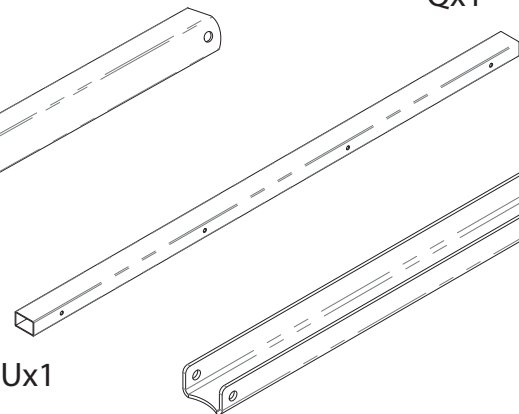

Ux1



Vx2

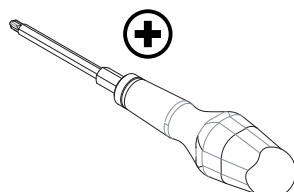
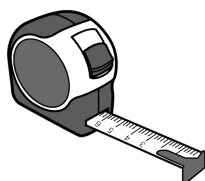

4-5mm

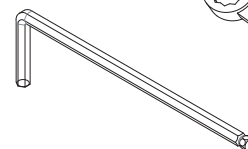

13mm

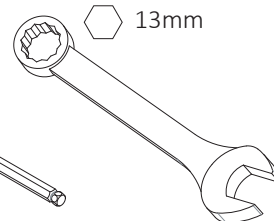

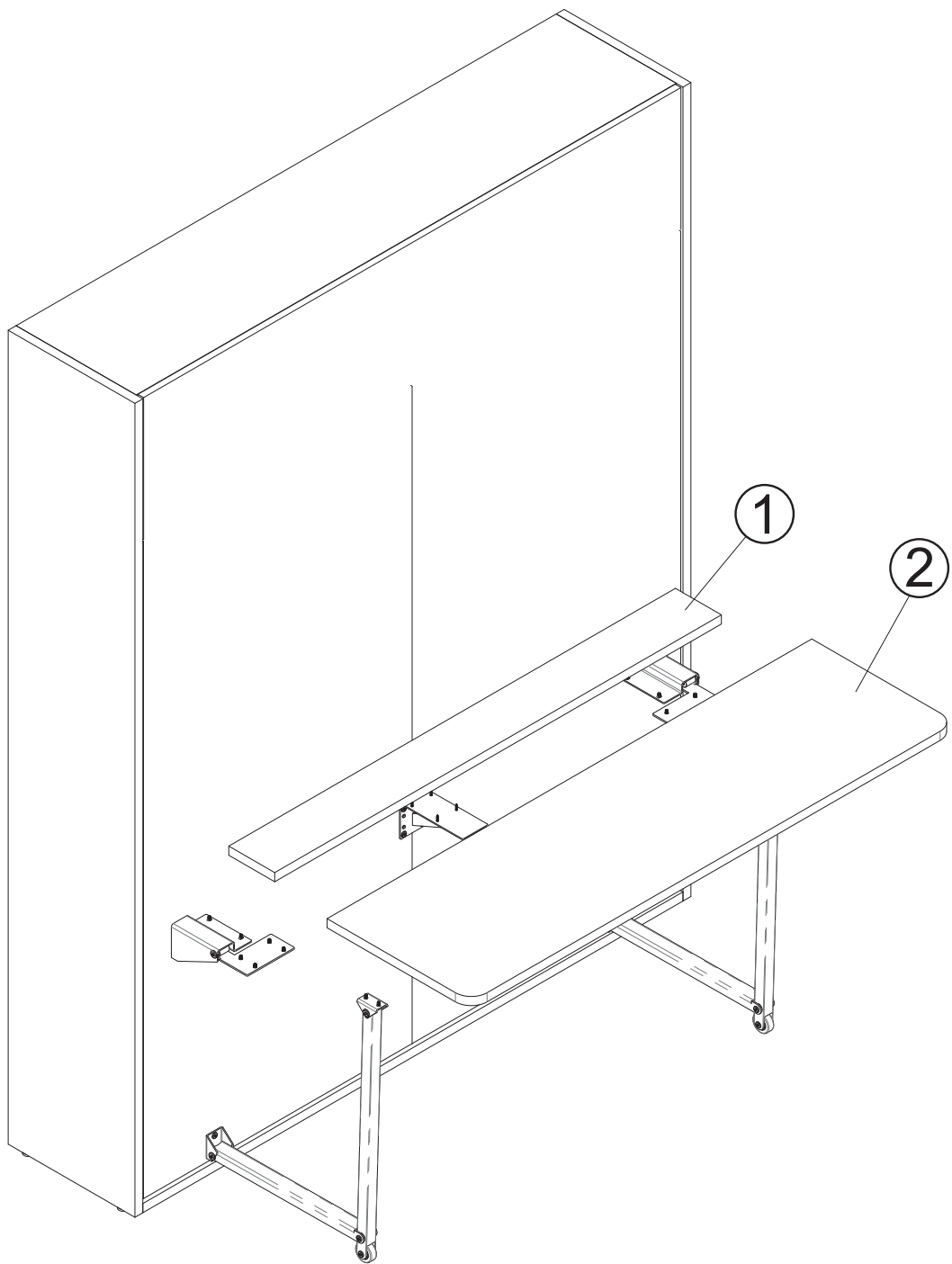

STEP 01



Uwaga:
Jeśli niektóre śruby znajdują się zbyt blisko krawędzi paneli, należy zmniejszyć ich ilość z 4 do 2 na płytce.
If some screws are too close to the edge of the panels, reduce the quantities from 4 to 2 a plate

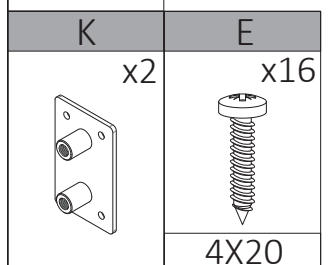
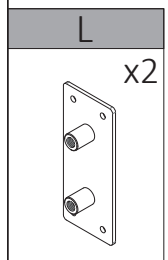
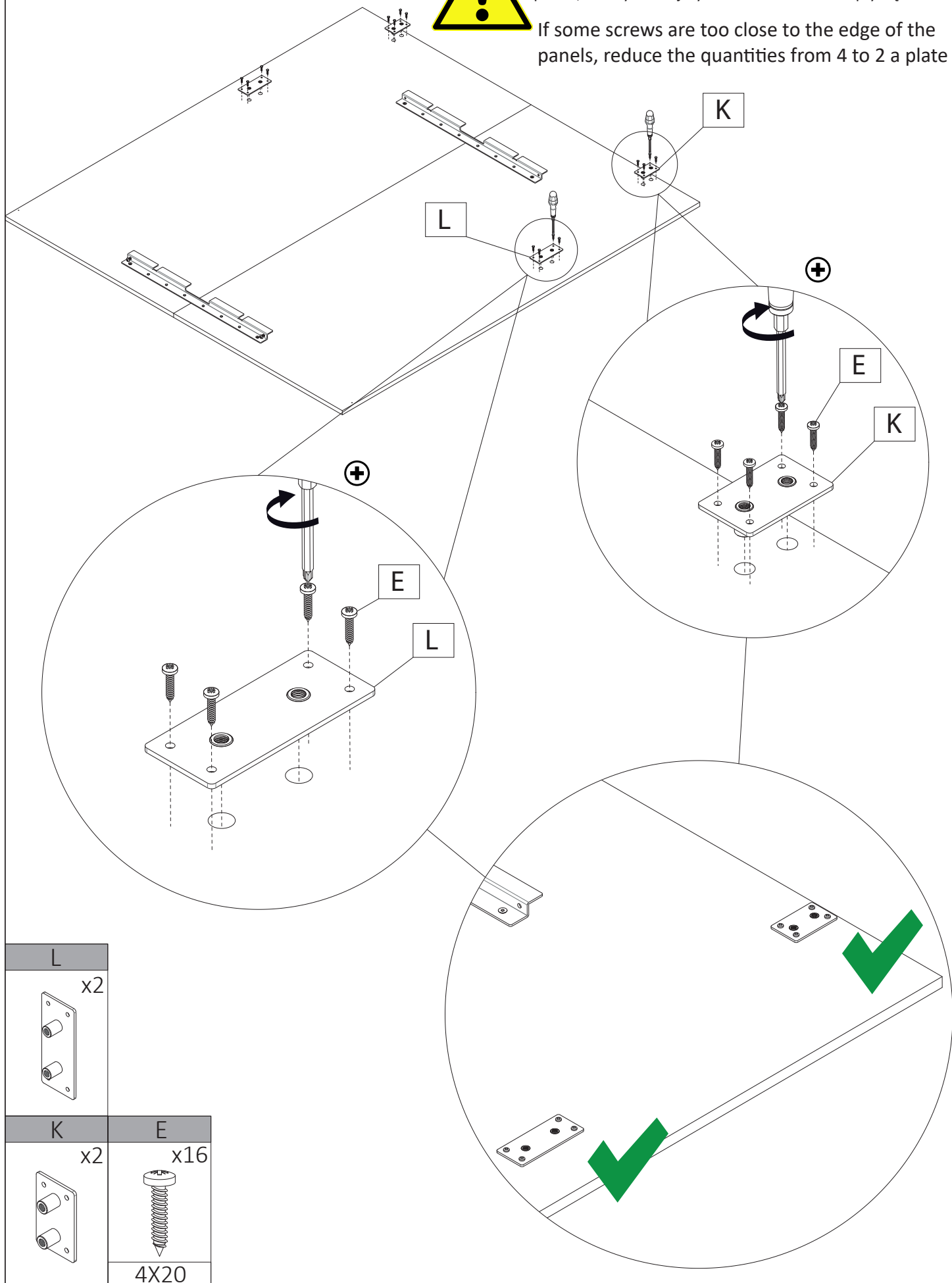

STEP 02

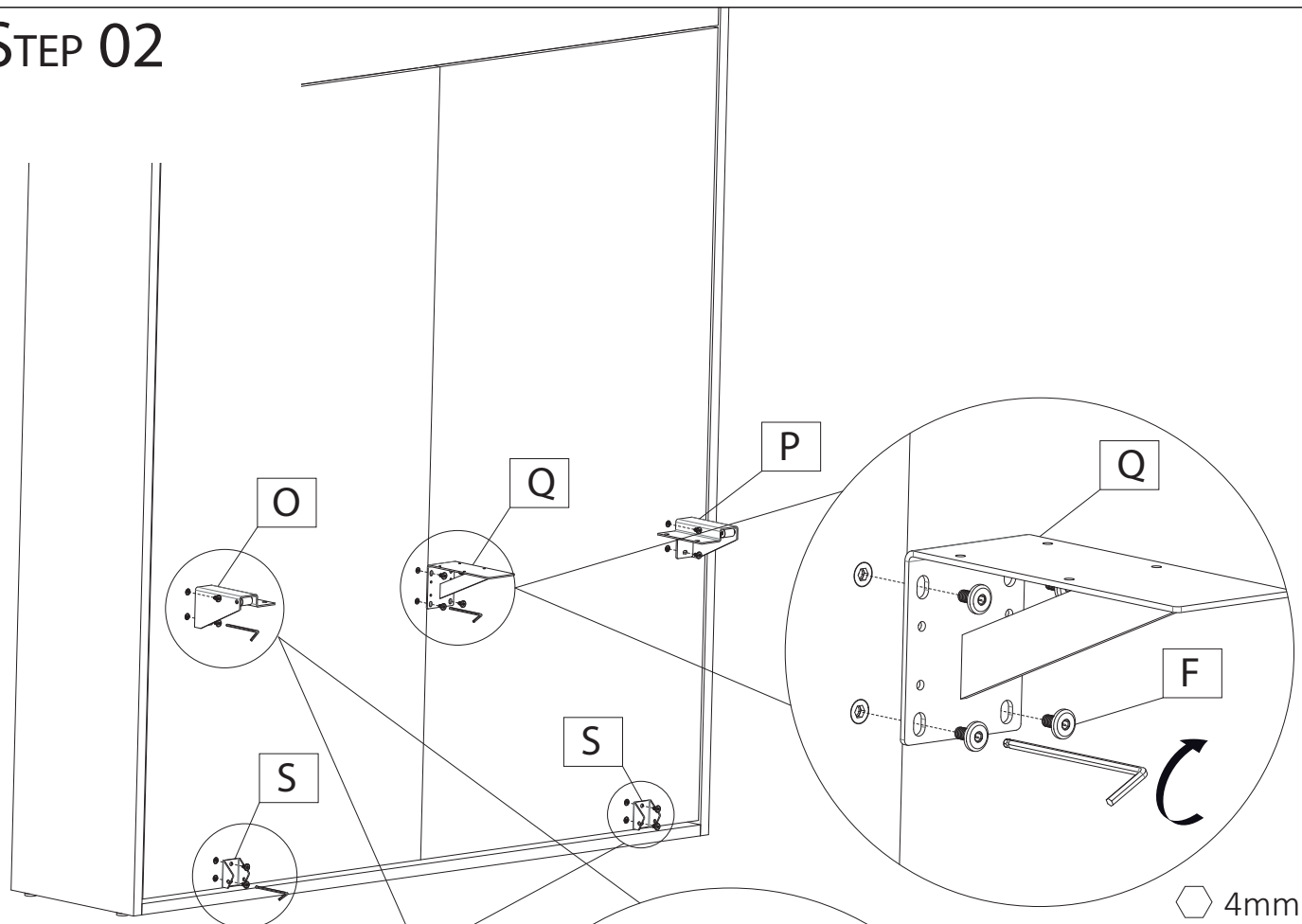

Hex 4mm

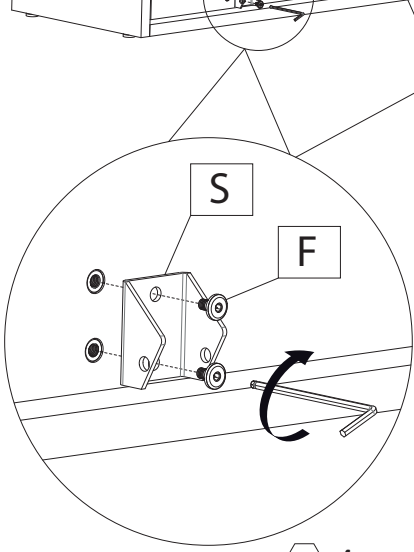

Hex 4mm

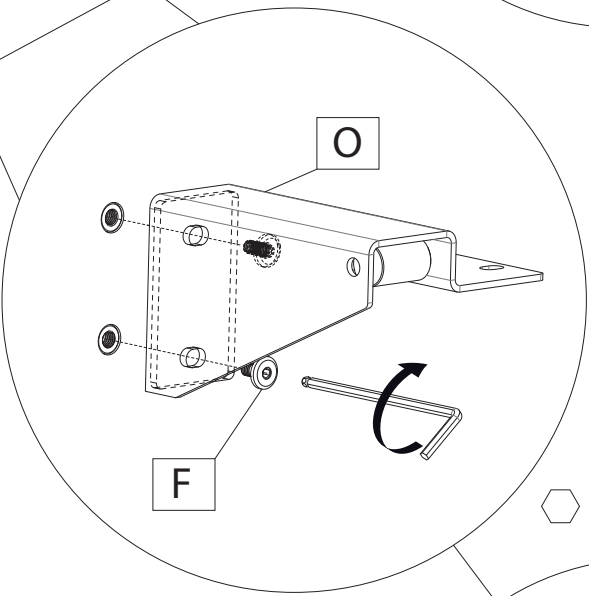

Hex 4mm

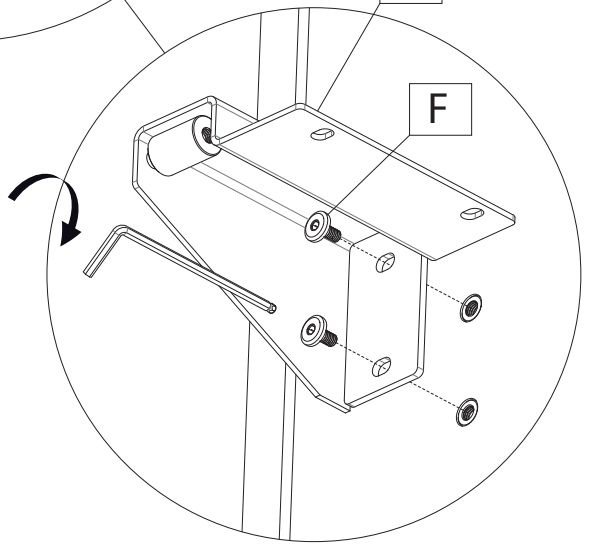

O	P	Q
x1	x1	x1
R	S	F
x2	x2	x12
		M6X12

STEP 03

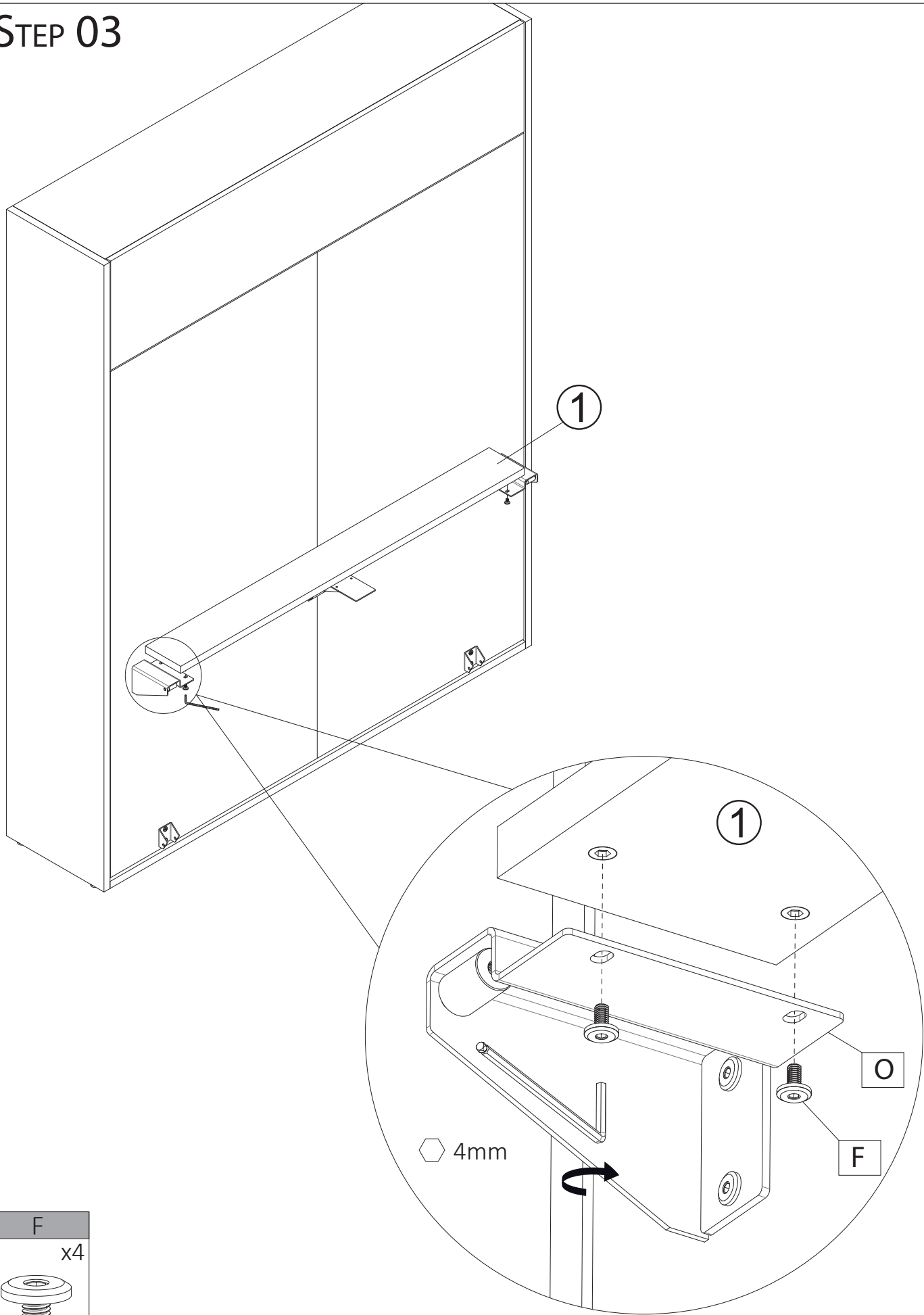

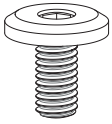
F
x4

M6X12

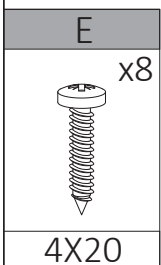
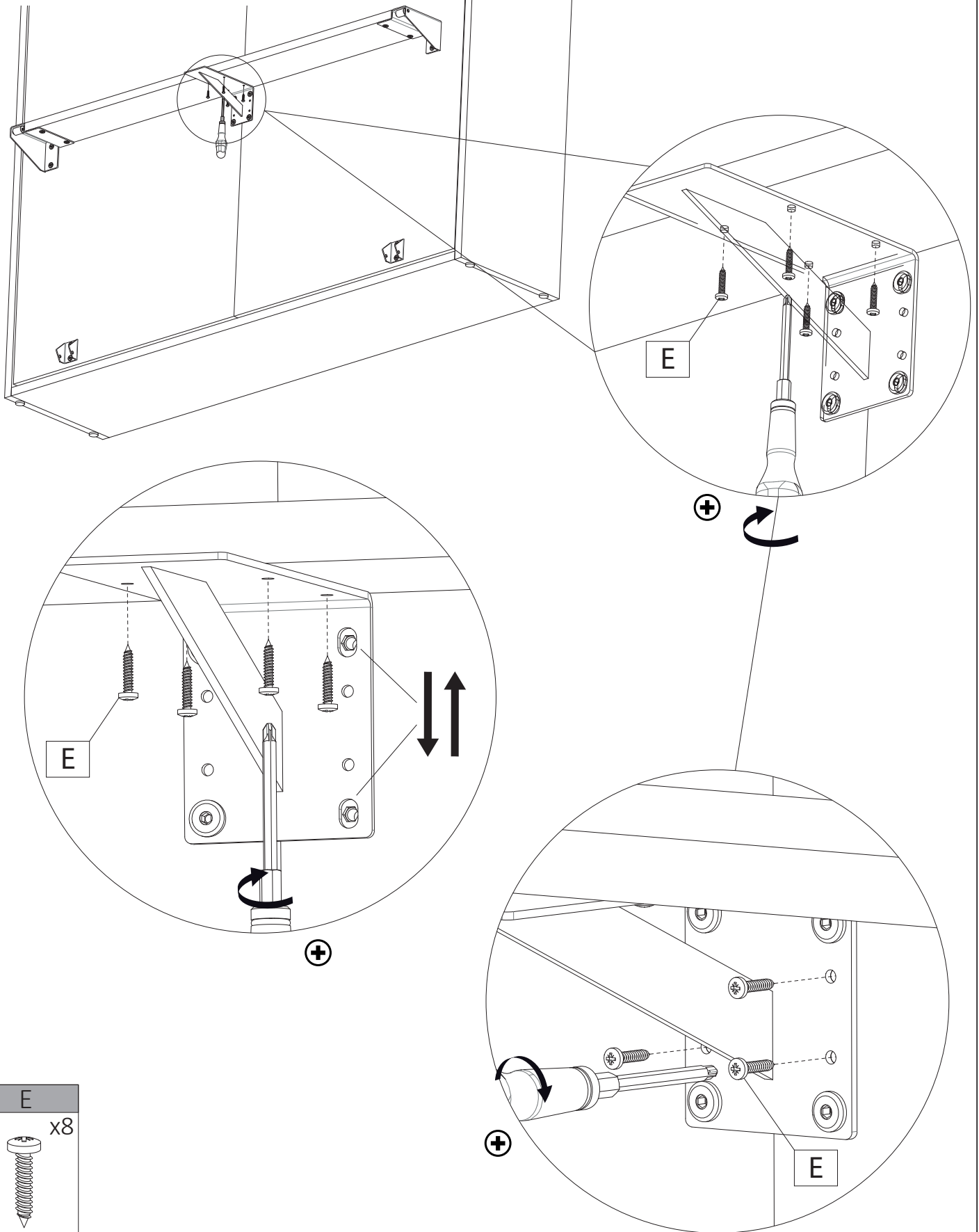
STEP 04

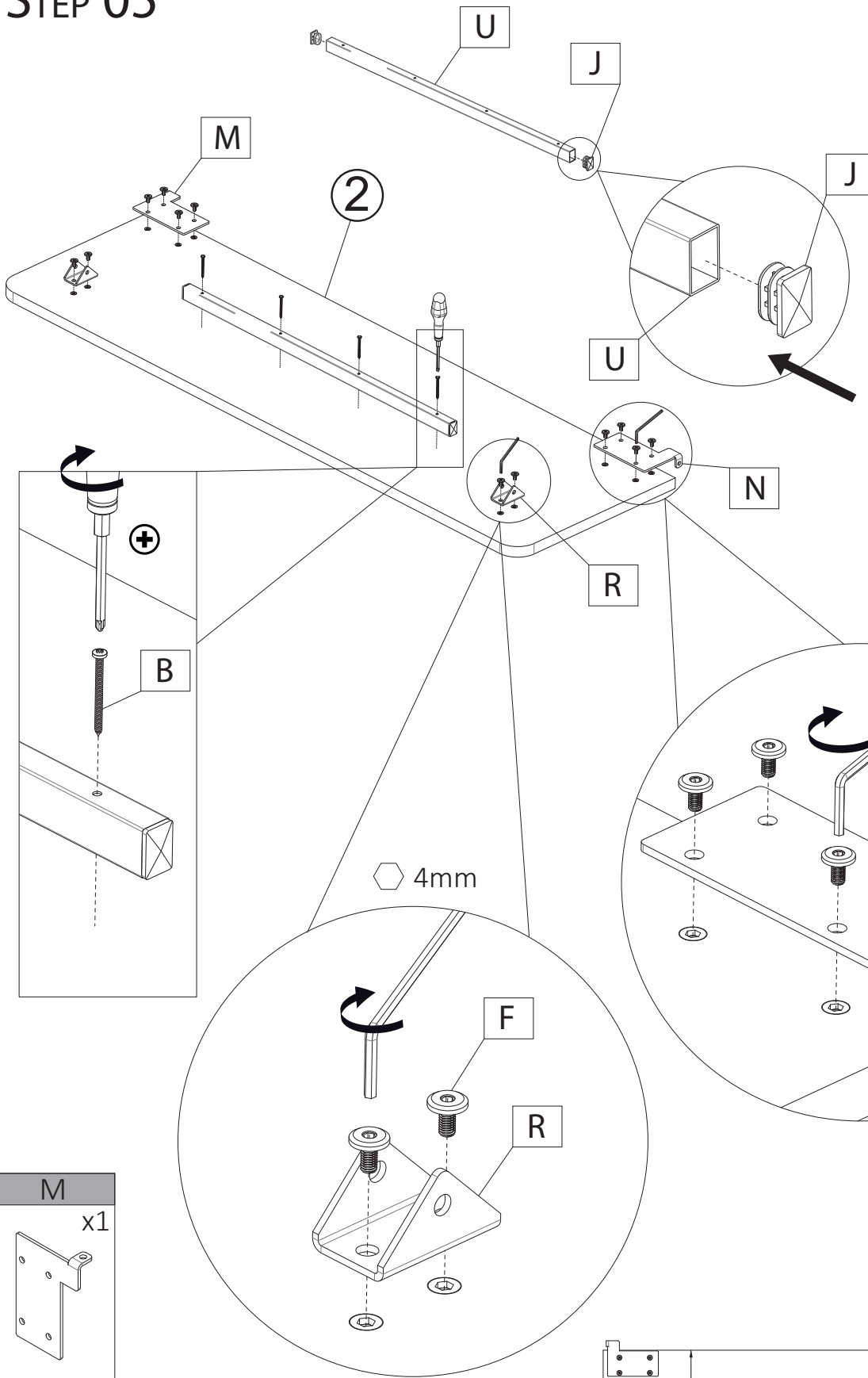

STEP 05



U	J
x1	x2
L.870 x4	B
L.920 x4	x4
L.1020 x4	
L.1220 x4	
L.1420 x4	
L.1620 x4	
L.1820 x4	4x50

M
x1

N	F	R
x1	x12	x2
	M6X12	

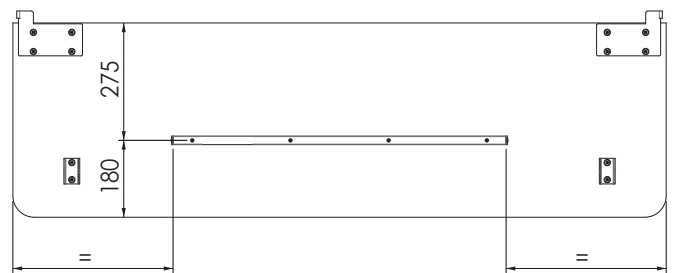

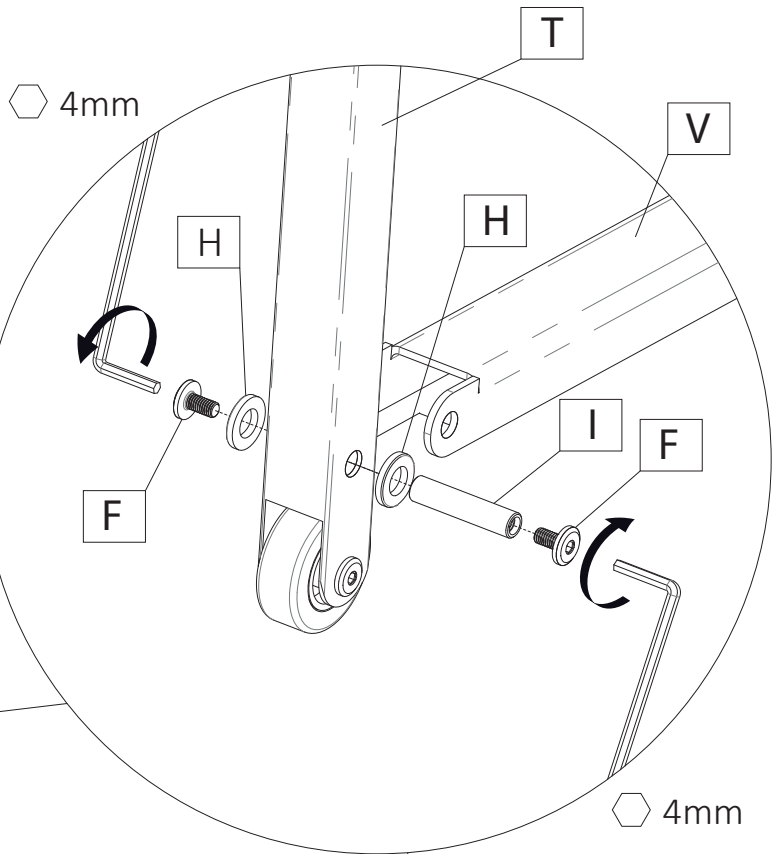

STEP 06

4mm

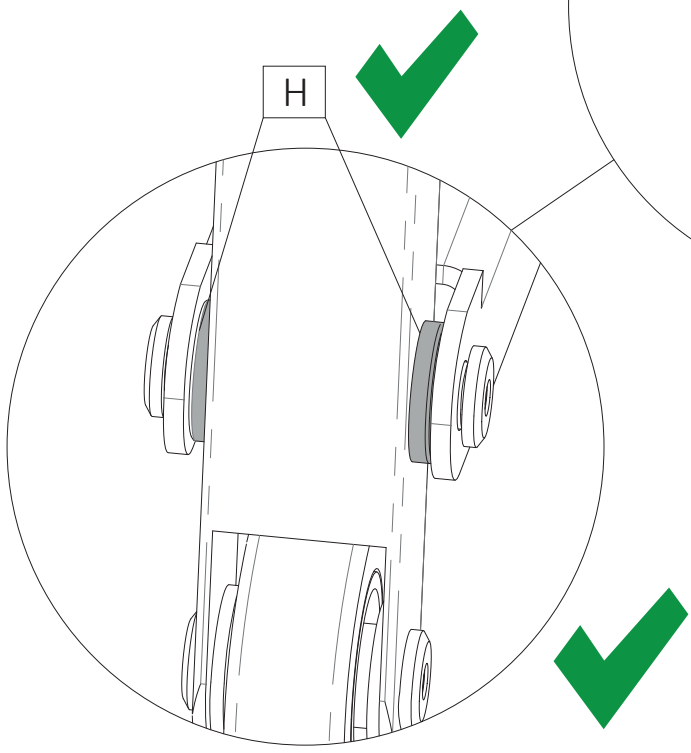
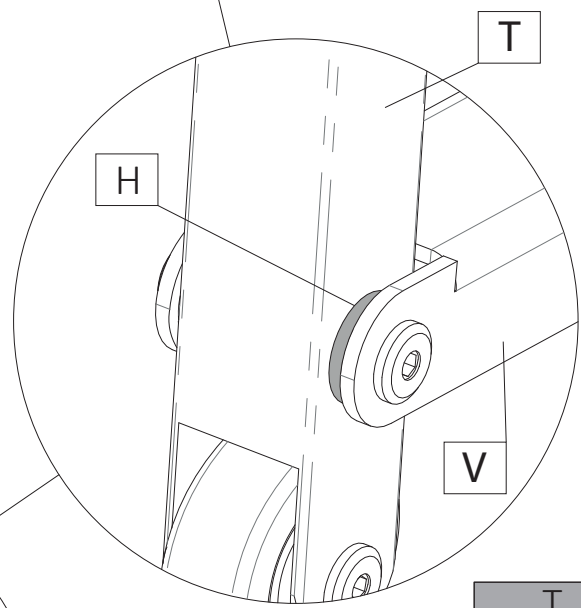
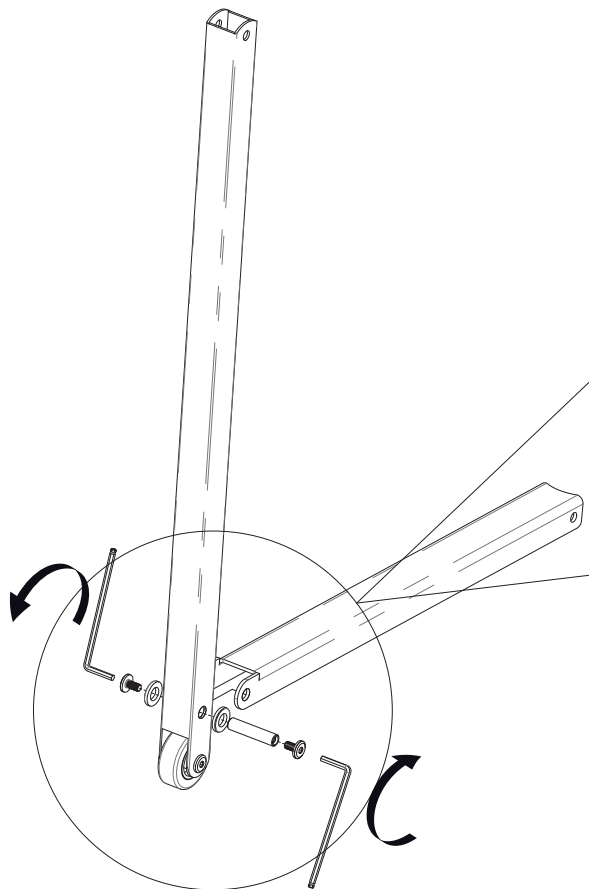

4mm

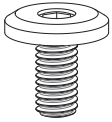

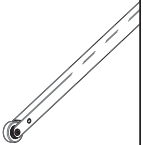
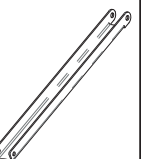

F	x4
	
M6X12	
H	x4
	
I	x2
	

T	x2
	
V	x2
	

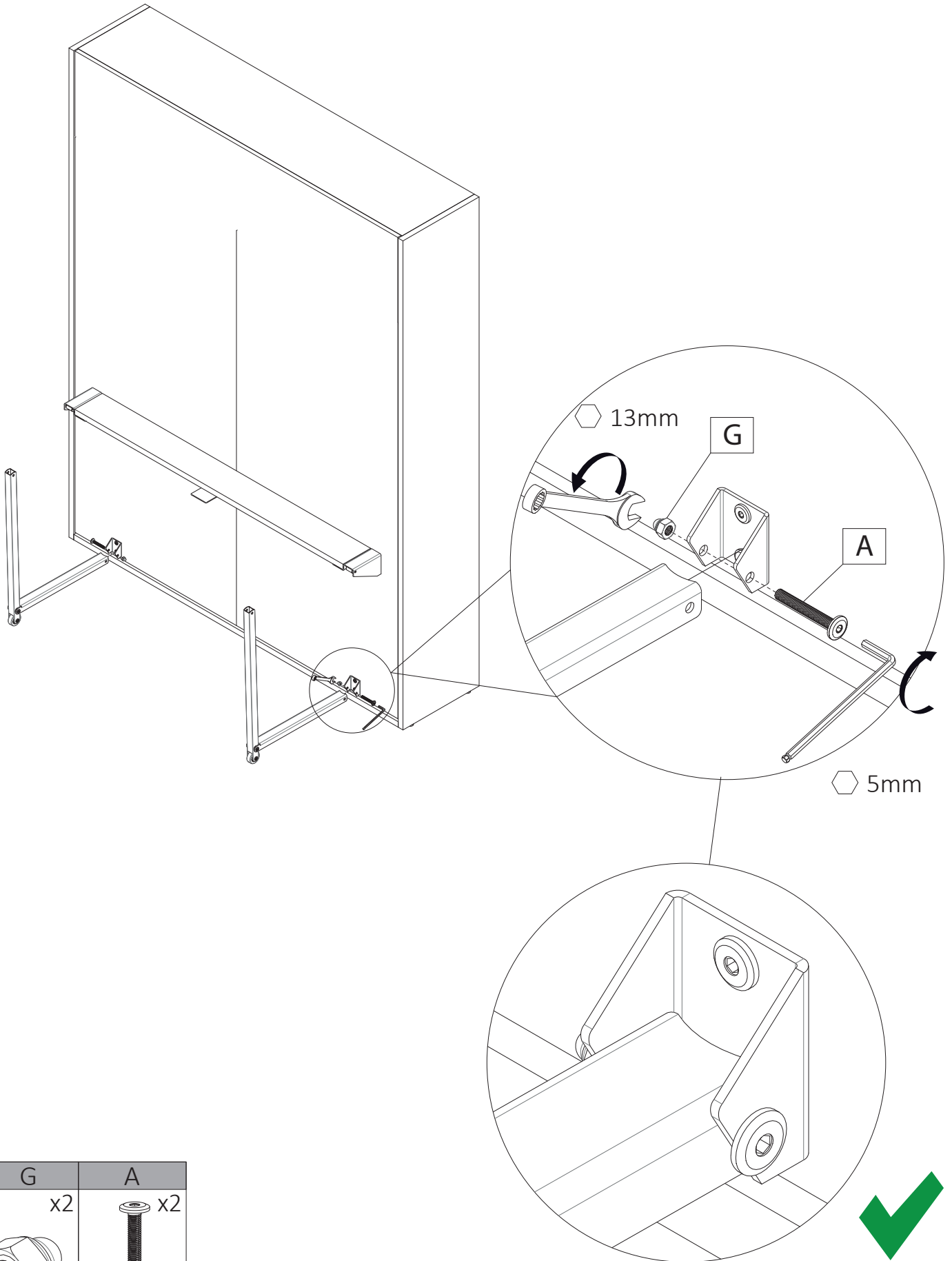
STEP 07

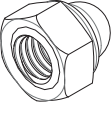

G	A
x2 	x2 
	M8X60

STEP 08

D	x2
M8X20	

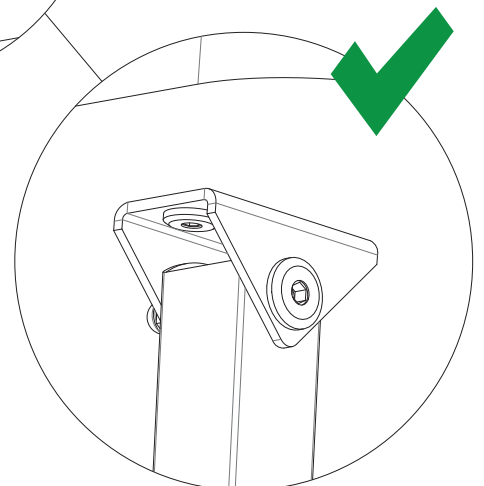
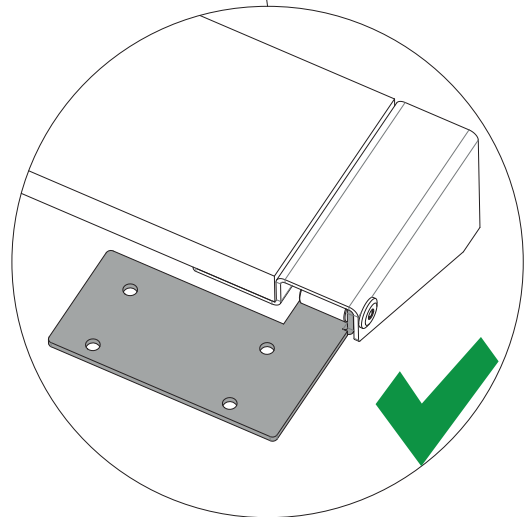
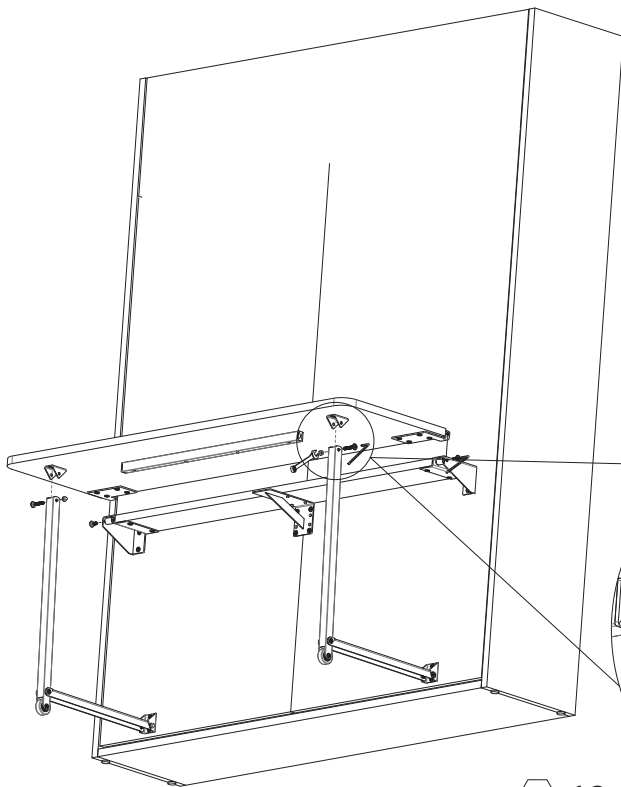
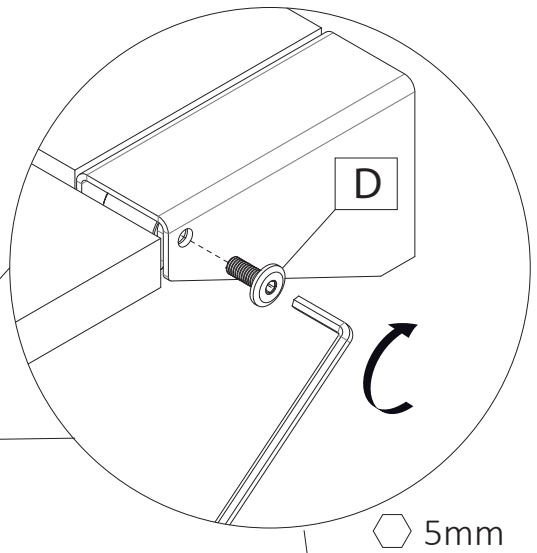
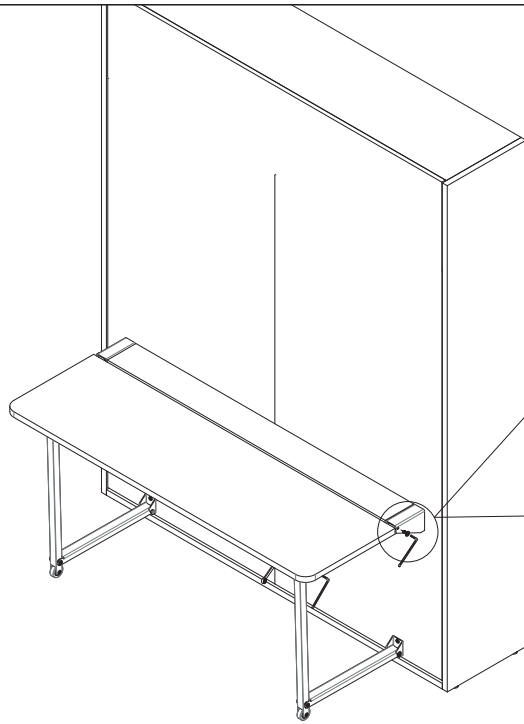

G	C
x2	x2
M8X45	

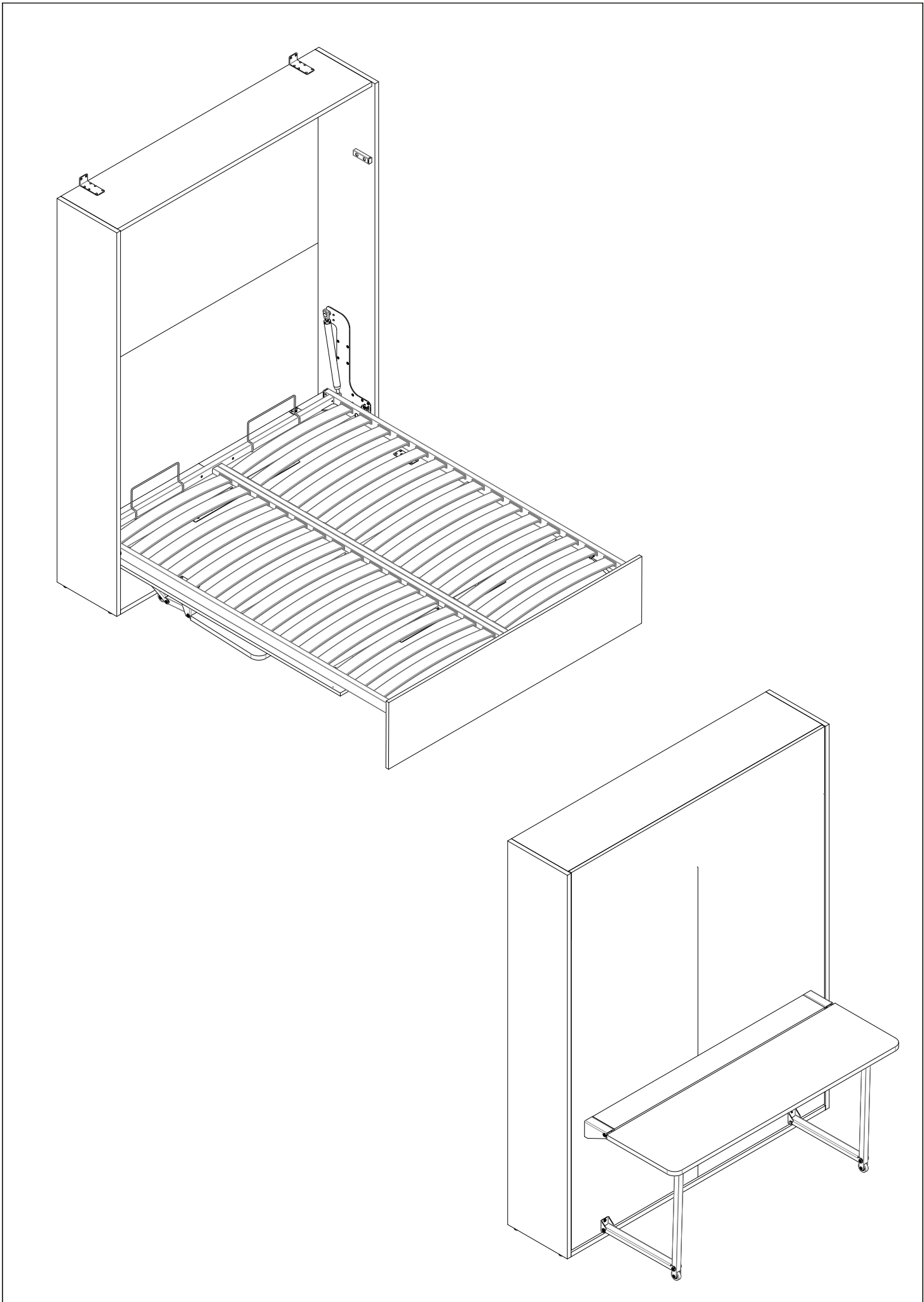

KONSERWACJA – CZYSZCZENIE – SMAROWANIE – UTYLIZACJA

Konserwacja

Konserwacja musi być wykonywana na wszystkich elementach mocujących, okresowo sprawdzając, czy wszystkie śruby i nakrętki samokontrujące nie są poluzowane, wygięte, uszkodzone lub brakujące.

Należy również sprawdzić, czy elementy stelaża, mechanizmu ruchu, sprężyny gazowe, mocowania do korpusu i do ściany nie są poluzowane, wygięte, uszkodzone lub brakujące.

Konserwacja musi być wykonywana co 60 cykli otwierania/zamykania i/lub co najmniej raz w roku.

Czyszczenie i smarowanie

Czyszczenie części metalowych należy wykonywać za pomocą gąbki i wilgotnej szmatki.

Nie używać rozpuszczalników ani materiałów ściernych.

Smarowanie elementów ruchomych, takich jak sworznie obrotowe i zawiasy drzwi, należy wykonywać co 60 cykli przy użyciu środka smarnego.

Utylizacja

Materiały, w przypadku wycofania produktu z użycia, muszą być utylizowane zgodnie z obowiązującymi przepisami prawa dotyczącymi gospodarki odpadami.



MAINTENANCE - CLEANING - LUBRIFICATION - DISPOSAL

MAINTENANCE

Make periodical check of all screwed on parts, including also the steadiness of the wall fixation, by checking that no elements are lose, folded, damaged or missing.

Also check that the elements of the bedspring, the handling mechanism, the gas springs, the attachment to the container and the wall are not loose, bent, damaged, or missing. Maintenance must be performed every 60 opening / closing cycles and / or at least once a year.

CLEANING AND LUBRIFICATION

The cleaning of all metal parts shall be made with a humid sponge or cloth.

Don't use any solvents or abrasive materials.

Lubrication of mobile elements as rotation pivots and door hinges, shall be made every 60 cycles with a lubricant.

DISPOSAL

The different parts shall be disposed in special containers in accordance with the ruling standards.

DO NOT DUMP.

